

ダイレクトタイプ スプレーノズル

# K-7

中部に入っている十字コアによって水が旋回し、遠心力により噴出穴から勢いよく、粗い水滴が噴出するタイプの円形全面(Full Cone)スプレーノズルです。またメンテナンスのため、十字コアは取り外しが可能です。

用途：工業用洗浄、冷却、金属表面前処理、防塵、煤煙除去、ガス脱臭、防火、塗装設備、化学的水処理など。

取付ネジ	R (管用テーパーおねじ)
管径	1/4 (8A)、3/8 (10A)、1/2 (15A)、3/4 (20A)
材質	BSBM (真鍮)、SUS304 (ステンレス)

**掲載区分**  
**円形全面スプレーノズル**

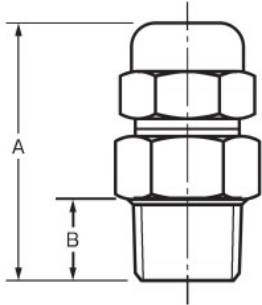

管径 in	寸法 mm		重量 g
	A	B	
1/4	32	10	30
3/8	38	11	50
1/2	49	14	100
3/4	60	17	200

管径 in	吹出穴 mm	水量 L/min / Spray角度													
		水圧 (MPa) (kg/cm <sup>2</sup> )	Spray角度												
			0.029	0.049	0.069	0.098	0.147	0.196	0.245	0.294	0.392	0.490	0.686	0.980	
1/4	2.0		1.60/40°	1.90/45°	2.45/50°	3.20/55°	3.60/55°	3.90/55°	4.20/55°	4.63/50°	5.00/50°	6.00/50°	6.50/45°		
	2.4	1.60/40°	2.00/45°	2.40/50°	2.90/55°	3.60/55°	4.30/60°	4.90/60°	5.40/60°	6.20/55°	6.90/50°	8.20/50°	9.40/45°		
	2.6	2.20/50°	2.70/55°	3.10/55°	3.65/60°	4.45/60°	5.20/60°	5.90/60°	6.50/60°	7.50/60°	8.40/50°	10.05/50°	11.40/50°		
	3.2	3.00/50°	3.80/55°	4.40/55°	5.20/60°	6.40/60°	7.40/60°	8.20/60°	8.80/60°	10.00/60°	11.00/55°	13.20/50°	14.80/50°		
3/8	2.8	2.70/40°	3.30/45°	3.80/45°	4.50/50°	5.40/50°	6.20/50°	6.80/50°	7.40/50°	8.40/45°	9.25/45°	11.00/45°	12.40/40°		
	3.2	4.00/45°	4.80/50°	5.30/50°	6.20/55°	7.30/55°	8.40/55°	9.30/55°	10.00/55°	11.20/50°	12.30/50°	14.60/46°	16.60/45°		
	3.6	4.60/45°	5.50/55°	6.30/55°	7.60/60°	9.20/60°	10.60/60°	11.80/60°	12.60/60°	14.00/55°	15.30/53°	18.20/50°	21.00/47°		
	4.0	6.00/50°	7.45/55°	8.40/60°	9.80/60°	12.00/65°	13.60/70°	14.60/70°	15.40/70°	17.30/65°	18.80/60°	22.00/55°	24.80/50°		
1/2	4.8	7.30/45°	8.90/60°	10.50/65°	12.90/70°	15.20/80°	17.05/85°	18.50/85°	19.60/85°	21.20/80°	23.00/80°	26.60/70°	29.60/70°		
	4.8	8.20/40°	10.50/45°	12.30/50°	14.40/60°	17.20/65°	19.20/65°	20.80/65°	22.40/65°	25.40/60°	28.00/55°	33.00/50°	37.00/50°		
	5.5	9.10/40°	11.50/45°	13.40/50°	16.30/60°	19.50/65°	21.80/65°	24.00/65°	26.20/65°	29.40/60°	32.40/55°	38.50/50°	44.00/50°		
	6.0	10.20/50°	12.90/60°	15.00/60°	17.90/65°	21.80/70°	24.60/75°	27.00/75°	28.70/75°	32.30/70°	35.90/65°	43.60/60°	50.10/60°		
3/4	6.4	11.40/50°	13.60/60°	15.40/65°	18.50/70°	22.60/80°	25.20/85°	28.30/85°	30.10/85°	34.80/80°	38.40/75°	46.40/70°	53.00/70°		
	6.4	13.20/60°	16.40/60°	19.20/60°	22.90/65°	27.00/70°	30.30/70°	32.50/70°	35.80/70°	40.00/65°	43.80/65°	53.00/60°	60.00/60°		
	7.5	16.60/60°	21.50/60°	24.40/65°	28.20/70°	35.20/75°	40.30/75°	43.80/75°	47.00/75°	53.00/70°	58.40/70°	70.00/65°	80.00/50°		
9.0	22.00/60°	26.00/65°	30.00/70°	36.00/75°	45.00/80°	49.80/85°	54.40/85°	58.80/85°	67.50/80°	74.50/75°	89.00/70°	100.00/70°			

※記載の数値は代表値であり、保証値ではありません。

