

タッチコネクターファイブ SUS

TOUCH CONNECTOR FIVE SUS

メイルブランチティ MALE BRANCH TEE

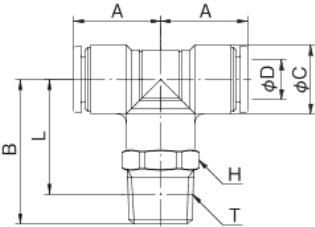

型式 Model		A	B	φC	適用 チューブ 外径 Tube O. D. φD	二面幅 Spanner Flats H	L	ねじサイズ Thread T (おねじ)	チューブ 挿入寸法 Tube Insertion Depth	重量 Weight (g)
本体色黒 Black body	本体色白 White body									
FS4-M5MT	FS4-M5MTW	14.8	19.0	10.0	4	10.0	16.0	M5×0.8	12.0	5.9
FS4-01MT	FS4-01MTW	14.8	22.5	10.0	4	10.0	18.5	R1/8	12.0	8.8
FS4-02MT	FS4-02MTW	14.8	26.5	10.0	4	14.0	20.5	R1/4	12.0	18.0
FS6-M5MT	FS6-M5MTW	15.8	20.0	12.0	6	12.0	17.0	M5×0.8	12.5	7.9
FS6-01MT	FS6-01MTW	15.8	24.5	12.0	6	12.0	20.5	R1/8	12.5	10.8
FS6-02MT	FS6-02MTW	15.8	27.5	12.0	6	14.0	21.5	R1/4	12.5	18.0
FS6-03MT	FS6-03MTW	15.8	29.5	12.0	6	17.0	23.1	R3/8	12.5	30.1
FS8-01MT	FS8-01MTW	17.8	26.5	14.0	8	14.0	22.5	R1/8	13.7	14.3
FS8-02MT	FS8-02MTW	17.8	29.5	14.0	8	14.0	23.5	R1/4	13.7	17.9
FS8-03MT	FS8-03MTW	17.8	31.5	14.0	8	17.0	25.1	R3/8	13.7	29.8
FS10-01MT	FS10-01MTW	19.8	29.5	17.0	10	17.0	25.5	R1/8	14.6	21.7
FS10-02MT	FS10-02MTW	19.8	32.5	17.0	10	17.0	26.5	R1/4	14.6	24.9
FS10-03MT	FS10-03MTW	19.8	33.5	17.0	10	17.0	27.1	R3/8	14.6	30.6
FS10-04MT	FS10-04MTW	19.8	36.5	17.0	10	21.0	28.5	R1/2	14.6	51.5
FS12-02MT	FS12-02MTW	22.3	35.0	20.0	12	19.0	29.0	R1/4	15.4	32.1
FS12-03MT	FS12-03MTW	22.3	36.0	20.0	12	21.0	29.6	R3/8	15.4	38.5
FS12-04MT	FS12-04MTW	22.3	39.0	20.0	12	21.0	31.0	R1/2	15.4	51.7

メイルブランチワイ MALE BRANCH Y

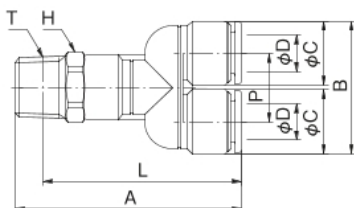

型式 Model		A	B	φC	適用 チューブ 外径 Tube O. D. φD	二面幅 Spanner Flats H	L	P	ねじサイズ Thread T (おねじ)	チューブ 挿入寸法 Tube Insertion Depth	重量 Weight (g)
本体色黒 Black body	本体色白 White body										
FS4-M5MY	FS4-M5MYW	35.8	20.8	10.0	4	10.0	32.8	10.8	M5×0.8	12.0	6.3
FS4-01MY	FS4-01MYW	39.3	20.8	10.0	4	10.0	35.3	10.8	R1/8	12.0	9.3
FS4-02MY	FS4-02MYW	43.3	20.8	10.0	4	14.0	37.3	10.8	R1/4	12.0	18.4
FS6-M5MY	FS6-M5MYW	38.4	25.0	12.0	6	12.0	35.4	13.0	M5×0.8	12.5	8.7
FS6-01MY	FS6-01MYW	42.9	25.0	12.0	6	12.0	38.9	13.0	R1/8	12.5	11.4
FS6-02MY	FS6-02MYW	45.9	25.0	12.0	6	14.0	39.9	13.0	R1/4	12.5	18.8
FS6-03MY	FS6-03MYW	47.9	25.0	12.0	6	17.0	41.5	13.0	R3/8	12.5	31.0
FS8-01MY	FS8-01MYW	46.4	29.0	14.0	8	14.0	42.4	15.0	R1/8	13.7	15.0
FS8-02MY	FS8-02MYW	49.4	29.0	14.0	8	14.0	43.4	15.0	R1/4	13.7	18.8
FS8-03MY	FS8-03MYW	51.4	29.0	14.0	8	17.0	45.0	15.0	R3/8	13.7	30.7
FS10-01MY	FS10-01MYW	52.7	35.0	17.0	10	17.0	48.7	18.0	R1/8	14.6	24.3
FS10-02MY	FS10-02MYW	55.7	35.0	17.0	10	17.0	49.7	18.0	R1/4	14.6	27.3
FS10-03MY	FS10-03MYW	56.7	35.0	17.0	10	17.0	50.3	18.0	R3/8	14.6	33.0
FS10-04MY	FS10-04MYW	59.7	35.0	17.0	10	21.0	51.7	18.0	R1/2	14.6	53.7
FS12-02MY	FS12-02MYW	59.3	41.0	20.0	12	19.0	53.3	21.0	R1/4	15.4	35.1
FS12-03MY	FS12-03MYW	60.3	41.0	20.0	12	21.0	53.9	21.0	R3/8	15.4	41.8
FS12-04MY	FS12-04MYW	63.3	41.0	20.0	12	21.0	55.3	21.0	R1/2	15.4	55.0