

タッチコネクタ H タイプ

TOUCH CONNECTOR H TYPE

ニップルコネクタ H タイプ [金属]

NIPPLE CONNECTOR H TYPE [METAL BODY]

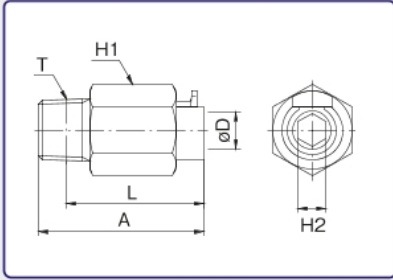

型式 Model	A	適用 チューブ外径 Tube O. D. ϕD	二面幅 Spanner Flats		L	ねじサイズ Thread T	挿入寸法 Tube Insert Length	外皮剥離寸法 Peeling Length for Spatter Tube	重量 Weight (g)
			H1	H2					
CKN-6-01H	33.4	6	14.0	4.0	29.4	R1/8	28.4	23.4	22.2
CKN-6-02H	33.4	6	14.0	4.0	27.4	R1/4	28.4	23.4	25.6
CKN-6-03H	33.4	6	17.0	4.0	27.0	R3/8	28.4	23.4	43.2
CKN-8-01H	37.4	8	17.0	5.0	33.4	R1/8	28.4	23.4	36.6
CKN-8-02H	35.4	8	17.0	6.0	29.4	R1/4	28.4	23.4	34.8
CKN-8-03H	32.4	8	17.0	6.0	26.0	R3/8	28.4	23.4	36.0
CKN-10-01H	41.9	10	19.0	5.0	37.9	R1/8	31.9	25.9	46.4
CKN-10-02H	39.9	10	19.0	6.0	33.9	R1/4	31.9	25.9	43.4
CKN-10-03H	38.9	10	19.0	8.0	32.5	R3/8	31.9	25.9	46.6
CKN-10-04H	35.9	10	21.0	8.0	27.9	R1/2	31.9	25.9	59.4
CKN-12-02H	47.4	12	21.0	7.0	41.4	R1/4	34.9	28.9	60.0
CKN-12-03H	44.9	12	21.0	9.0	38.5	R3/8	34.9	28.9	60.4
CKN-12-04H	45.4	12	21.0	9.0	37.4	R1/2	34.9	28.9	71.2

エルボコネクタ H タイプ [金属]

ELBOW CONNECTOR H TYPE [METAL BODY]

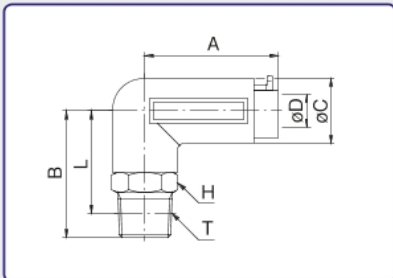

型式 Model	A	B	ϕC	適用 チューブ外径 Tube O. D. ϕD	二面幅 Spanner Flats H	L	ねじサイズ Thread T	挿入寸法 Tube Insert Length	外皮剥離寸法 Peeling Length for Spatter Tube	重量 Weight (g)
CKL-6-02H	30.9	30.0	14.0	6	14.0	24.0	R1/4	28.4	23.4	48.0
CKL-6-03H	30.9	31.0	14.0	6	17.0	24.6	R3/8	28.4	23.4	58.4
CKL-8-01H	32.4	28.0	16.0	8	14.0	24.0	R1/8	28.4	23.4	64.8
CKL-8-02H	32.4	31.0	16.0	8	14.0	25.0	R1/4	28.4	23.4	65.4
CKL-8-03H	32.4	32.0	16.0	8	17.0	25.6	R3/8	28.4	23.4	72.8
CKL-10-01H	35.9	28.0	18.0	10	17.0	24.0	R1/8	31.9	25.9	67.4
CKL-10-02H	35.9	31.0	18.0	10	17.0	25.0	R1/4	31.9	25.9	72.8
CKL-10-03H	35.9	32.0	18.0	10	17.0	25.6	R3/8	31.9	25.9	76.6
CKL-10-04H	35.9	36.0	18.0	10	21.0	28.0	R1/2	31.9	25.9	88.6
CKL-12-02H	39.4	35.0	21.0	12	19.0	29.0	R1/4	34.1	28.1	103.2
CKL-12-03H	39.4	36.0	21.0	12	19.0	29.6	R3/8	34.1	28.1	107.8
CKL-12-04H	39.4	39.0	21.0	12	21.0	31.0	R1/2	34.1	28.1	121.2

ユニオンティ H タイプ [金属]

UNION TEE H TYPE [METAL BODY]

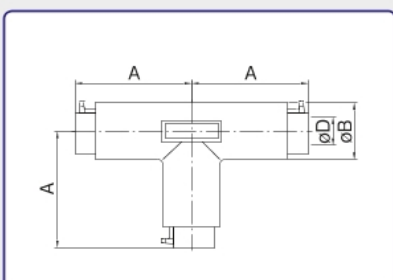

型式 Model	A	ϕB	適用 チューブ外径 Tube O. D. ϕD	挿入寸法 Tube Insert Length	外皮剥離寸法 Peeling Length for Spatter Tube	重量 Weight (g)
CUT-6-00H	31.9	14.0	6	28.4	23.4	64.4
CUT-8-00H	32.9	16.0	8	28.4	23.4	76.0
CUT-10-00H	37.4	18.0	10	31.9	25.9	101.2
CUT-12-00H	41.4	21.0	12	34.9	28.9	146.2