

側刃付キーシードカッター Keyseat Cutter With Side Cutting Edge

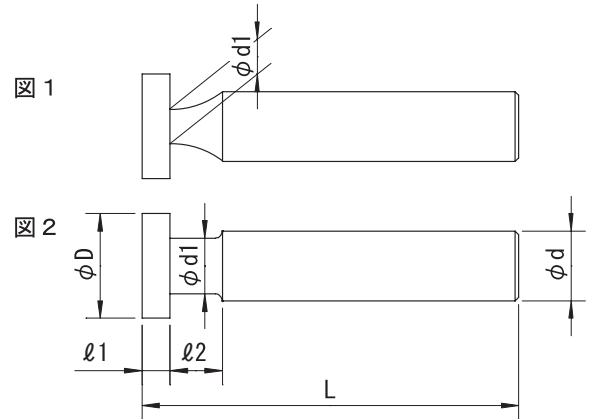

公差 (Tolerance)	D		l1	d			
	8~16	+0.3 +0.18	19~25		+0.35 +0.21	1~1.8	-0.014 -0.028
	30~40	+0.43 +0.26					h8

右刃ストレート SKH51
Straight Flute HSS

刃径 (ΦD)	刃厚 (ℓ1)	首径 (d1)	首長 (ℓ2)	全長 (L)	シャンク径 (Φd)	刃数 (N)	形状
Dia.	Cut Width	Neck Dia.	Neck Length	Overall Length	Shank Dia.	Number of Flutes	Shape
8	1	3.7	6	50	8	8	図1
	1.2	3.7	6	50	8	8	
	1.5	3.7	6	50	8	8	
	1.6	3.7	6	50	8	8	
1.8	3.7	6	50	8	8		
10	1	4.2	5.8	50	8	8	
	1.2	4.2	5.8	50	8	8	
	1.5	4.2	5.8	50	8	8	
	1.6	4.2	5.8	50	8	8	
1.8	4.2	5.8	50	8	8		
12	1	4.4	7	50	10	8	
	1.2	4.4	7	50	10	8	
	1.5	4.4	7	50	10	8	
	1.6	4.4	7	50	10	8	
1.8	4.4	7	50	10	8		
15	1	4.7	7.8	50	10	10	
	1.2	4.7	7.8	50	10	10	
	1.5	4.7	7.8	50	10	10	
	1.6	4.7	7.8	50	10	10	
1.8	4.7	7.8	50	10	10		
16	1	5	8.8	60	12	10	
	1.2	5	8.8	60	12	10	
	1.5	5	8.8	60	12	10	
	1.6	5	8.8	60	12	10	
1.8	5	8.8	60	12	10		
19	1	8	8.7	60	12	12	
	1.2	8	8.7	60	12	12	
	1.5	8	8.7	60	12	12	
	1.6	8	8.7	60	12	12	
1.8	8	8.7	60	12	12		

刃径 (ΦD)	刃厚 (ℓ1)	首径 (d1)	首長 (ℓ2)	全長 (L)	シャンク径 (Φd)	刃数 (N)	形状
Dia.	Cut Width	Neck Dia.	Neck Length	Overall Length	Shank Dia.	Number of Flutes	Shape
20	1	8	8.7	60	12	12	図1
	1.2	8	8.7	60	12	12	
	1.5	8	8.7	60	12	12	
	1.6	8	8.7	60	12	12	
1.8	8	8.7	60	12	12		
22	1	9	8.5	60	12	12	
	1.2	9	8.5	60	12	12	
	1.5	9	8.5	60	12	12	
	1.6	9	8.5	60	12	12	
1.8	9	8.5	60	12	12		
25	1	10	12	65	12	14	
	1.2	10	12	65	12	14	
	1.5	10	12	65	12	14	
	1.6	10	12	65	12	14	
1.8	10	12	65	12	14		
30	1	10	24	70	12	14	
	1.2	10	23.8	70	12	14	
	1.5	10	23.5	70	12	14	
	1.6	10	23.4	70	12	14	
1.8	10	23.2	70	12	14		
35	1	10	24	75	12	16	
	1.2	10	23.8	75	12	16	
	1.5	10	23.5	75	12	16	
	1.6	10	23.4	75	12	16	
1.8	10	23.2	75	12	16		
40	1	10	24	75	12	16	
	1.2	10	23.8	75	12	16	
	1.5	10	23.5	75	12	16	
	1.6	10	23.4	75	12	16	
1.8	10	23.2	75	12	16		