

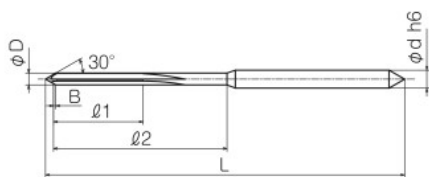

■ 寸法表 [A Series Specification Table]

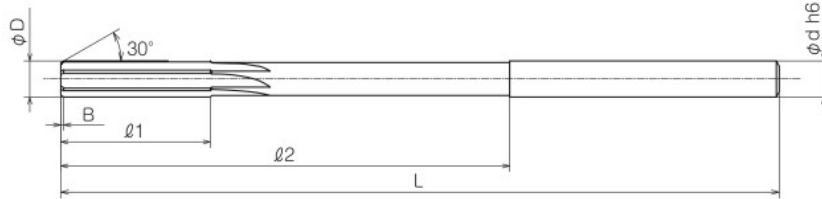

(φ1.000mm~φ2.905mm形状)
(φ1.000mm - φ2.905mm Dia. shape)



(φ2.910mm~φ18.030mm形状)
(φ2.910mm - φ18.030mm Dia. shape)

刃径公差 (+0.005)
(Tolerance) **(0**

0.005mmとび
Increment
単価:円 unit price: in JPY

型式・刃径φD Diameter (呼び寸法)	刃長 φ1 Flute Length	首下長 φ2 Body Length		全長 L Overall Length		シャンク径 φd Shank Diameter	食付き長B Chamfer Length	刃数 Number of Flutes	標準定価 Retail Price 0.005mmとび Increment	
		標準	※対応範囲	標準	※対応範囲					
CA 1.000~1.305	10	27	(20~27)	60	(50~60)	3.0突出し センタ	0.2	4	22,000	
CA 1.310~1.505			(20~37)		(50~70)				22,000	
CA 1.510~2.005			(25~39)		(50~80)				21,000	
CA 2.010~2.505	15	29	(25~49)	80	(60~90)	3.0穴センタ	0.5	4	21,000	
CA 2.510~2.905			(25~49)						(50~80)	20,000
CA 2.910~3.005	20	50	(30~60)	100	(60~110)	4.0	0.5	4	22,000	
CA 3.010~3.505			(30~70)						(60~100)	22,000
CA 3.510~4.005			(30~75)						(60~110)	24,000
CA 4.010~4.505	25	65	(35~85)	120	(70~120)	6.0	0.8	6	24,900	
CA 4.510~5.005			(35~105)						(70~150)	25,700
CA 5.010~5.505			(35~115)						(80~160)	26,000
CA 5.510~6.005	25	75	(35~115)	120	(80~160)	6.0	0.8	6	26,000	
CA 6.010~6.505			(35~135)						(80~180)	30,000
CA 6.510~7.005			(35~135)						(80~180)	30,000
CA 7.010~7.505	30	85	(35~135)	130	(90~180)	8.0	1.0	8	30,000	
CA 7.510~8.005			(35~135)						(90~180)	30,000
CA 8.010~8.505			(45~135)						(90~180)	34,000
CA 8.510~9.005	30	100	(45~135)	150	(90~180)	10.0	1.0	8	34,000	
CA 9.010~9.505			(45~135)						(90~180)	34,000
CA 9.510~10.005			(45~135)						(90~180)	36,500
CA 10.010~10.505	30	100	(45~135)	150	(90~180)	12.0	1.0	8	43,000	
CA 10.510~11.005			(40~130)						(90~180)	43,000
CA 10.510~11.005			(40~130)						(90~180)	43,000
CA 11.010~11.505	30	100	(40~130)	150	(90~180)	14.0	1.0	8	43,000	
CA 11.510~12.005			(40~130)						(90~180)	48,700
CA 12.010~12.505			(40~130)						(90~180)	53,000
CA 12.510~13.005	30	100	(40~130)	150	(90~180)	14.0	1.0	8	53,000	
CA 13.010~13.595			(40~130)						(90~180)	53,400
CA 13.600~14.005			(40~130)						(90~180)	53,400
CA 14.010~14.505	30	120	(40~120)	180	(100~180)	16.0	1.2	8	72,000	
CA 14.510~15.005			(40~120)						(100~180)	72,000
CA 15.010~15.505			(40~120)						(100~180)	74,000
CA 15.510~16.005	30	120	(40~120)	180	(100~180)	16.0	1.2	8	74,000	
CA 16.010~16.505			(40~120)						(100~180)	83,600
CA 16.510~17.005			(40~120)						(100~180)	83,600
CA 17.010~17.505	30	120	(40~120)	180	(100~180)	18.0	1.2	8	85,500	
CA 17.510~18.030			(40~120)						(100~180)	85,500

※首下長、全長の ()内は対応可能範囲となります。
価格に関しては、別途お問い合わせください。

※Body length, Overall length in parentheses are available range.
Please contact us for pricing.

受注生産につき、3本以上/1オーダーからの製作になります。
Made-to-order from 3pcs/size for order.