

## ■ はんだタイプコネクタユニット

### ● 雄コネクタ

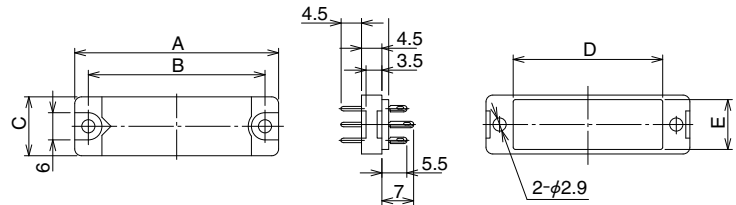
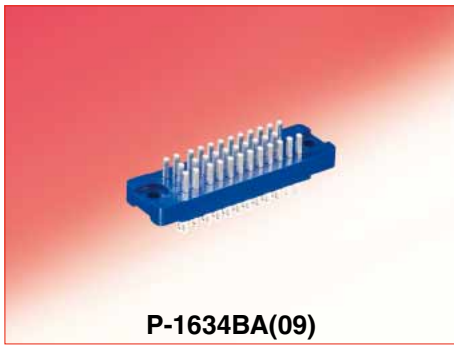

単位：mm

| 極数 | Aタイプ          |               | Gタイプ          |               | A  | B  | C  | D  | E  | RoHS |
|----|---------------|---------------|---------------|---------------|----|----|----|----|----|------|
|    | 製品番号          | HRS No.       | 製品番号          | HRS No.       |    |    |    |    |    |      |
| 8  | *P-1608BA(09) | 216-0171-5 09 | *P-1608BG(09) | 216-0180-6 09 | 25 | 19 | 10 | 13 | 8  | ○    |
| 12 | *P-1612BA(09) | 216-0172-8 09 | *P-1612BG(09) | 216-0181-9 09 | 30 | 24 |    | 18 |    |      |
| 16 | *P-1616BA(09) | 216-0173-0 09 | *P-1616BG(09) | 216-0182-1 09 | 35 | 29 |    | 23 |    |      |
| 20 | *P-1620BA(09) | 216-0174-3 09 | *P-1620BG(09) | 216-0183-4 09 | 33 | 27 | 13 | 21 | 11 |      |
| 24 | *P-1624BA(09) | 216-0175-6 09 | *P-1624BG(09) | 216-0184-7 09 | 37 | 31 |    | 25 |    |      |
| 28 | *P-1628BA(09) | 216-0176-9 09 | *P-1628BG(09) | 216-0185-0 09 | 40 | 34 |    | 28 |    |      |
| 34 | *P-1634BA(09) | 216-0177-1 09 | *P-1634BG(09) | 216-0186-2 09 | 45 | 39 |    | 33 |    |      |
| 45 | *P-1645BA(09) | 216-0178-4 09 | *P-1645BG(09) | 216-0187-5 09 | 54 | 48 |    | 42 |    |      |
| 60 | *P-1660BA(09) | 216-0179-7 09 | *P-1660BG(09) | 216-0188-8 09 | 67 | 61 | 55 |    |    |      |

\*印は標準品

### ● 雌コネクタ

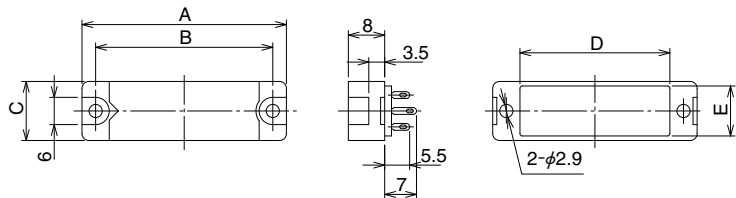
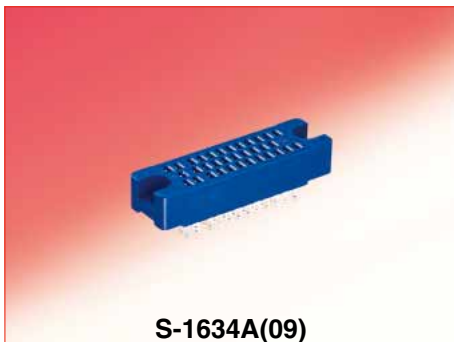

単位：mm

| 極数 | Aタイプ         |               | Gタイプ         |               | A  | B  | C  | D  | E  | RoHS |
|----|--------------|---------------|--------------|---------------|----|----|----|----|----|------|
|    | 製品番号         | HRS No.       | 製品番号         | HRS No.       |    |    |    |    |    |      |
| 8  | *S-1608A(09) | 216-0001-5 09 | *S-1608G(09) | 216-0055-4 09 | 25 | 19 | 10 | 13 | 8  | ○    |
| 12 | *S-1612A(09) | 216-0002-8 09 | *S-1612G(09) | 216-0056-7 09 | 30 | 24 |    | 18 |    |      |
| 16 | *S-1616A(09) | 216-0003-0 09 | *S-1616G(09) | 216-0057-0 09 | 35 | 29 |    | 23 |    |      |
| 20 | *S-1620A(09) | 216-0004-3 09 | *S-1620G(09) | 216-0058-2 09 | 33 | 27 | 13 | 21 | 11 |      |
| 24 | *S-1624A(09) | 216-0005-6 09 | *S-1624G(09) | 216-0059-5 09 | 37 | 31 |    | 25 |    |      |
| 28 | *S-1628A(09) | 216-0006-9 09 | *S-1628G(09) | 216-0060-4 09 | 40 | 34 |    | 28 |    |      |
| 34 | *S-1634A(09) | 216-0007-1 09 | *S-1634G(09) | 216-0061-7 09 | 45 | 39 |    | 33 |    |      |
| 45 | *S-1645A(09) | 216-0008-4 09 | *S-1645G(09) | 216-0062-0 09 | 54 | 48 |    | 42 |    |      |
| 60 | *S-1660A(09) | 216-0009-7 09 | *S-1660G(09) | 216-0063-2 09 | 67 | 61 | 55 |    |    |      |

\*印は標準品