

RESIN COLLARS -SHOULDER TYPE-

樹脂カラー

ツバ付タイプ

◎カタログ規格外品はこちら P.137



寸法選択タイプ	寸法フリー指定タイプ	材質	色
CLJHJ	FCLJHJ	ポリアセタール	白
CLJHK	FCLJHK		黒
CLJHM	FCLJHM	MCナイロン	青
CLJHW	FCLJHW	スタンダードグレード	アイボリー
CLJHD	FCLJHD	MCナイロン	黒
CLJHT	FCLJHT	導電性グレード	
CLJHB	FCLJHB	ベークライト	紙系 自然色
CLJHN	FCLJHN	ベークライト	布系 自然色
CLJHF	FCLJHF	フッ素樹脂	白
CLJHP	FCLJHP	PEEK	灰
CLJHE	FCLJHE	エポキシガラス	緑

寸法選択タイプ

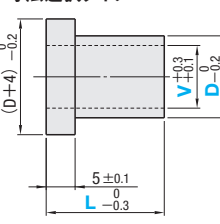

寸法フリー指定タイプ

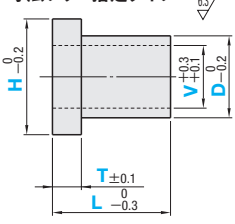

◎材質特性 P.173

■寸法選択タイプ

型式	D	L	¥基準単価									
			CLJHJ CLJHK	CLJHM CLJHW	CLJHD	CLJHB	CLJHN	CLJHT	CLJHF	CLJHP	CLJHE	
Type	V	0.5mm 単位										
	選択	単位										
2	(4) 5 6 8 10	(4) ...V2のみ	10.0~25.0	280	310	750	260	510	750	1,350	3,600	1,030
			25.5~30.0	310	330	810	290	530	810	2,490	4,970	2,090
3	(6) 8 10 11 12 13 14 15 16 20 25	(6) ...V4のみ	10.0~25.0	280	310	780	260	510	810	2,990	7,650	1,280
			25.5~50.0	310	330	830	290	530	880	6,090	11,220	2,630
4	8 10 11 12 13 14 15 16 20 25		10.0~25.0	310	330	810	290	530	810	2,990	7,650	1,600
			25.5~50.0	330	360	880	310	560	880	6,090	11,220	3,070
5	10 11 12 13 14 15 16 20 25 30		10.0~25.0	350	380	920	330	580	920	4,030	8,840	2,490
			25.5~50.0	380	400	980	360	600	980	7,800	13,150	4,700
6	12 13 14 15 16 20 25 30		50.5~75.0	410	450	1,090	390	650	1,090	-	-	-
			75.5~100.0	500	540	1,300	480	740	1,300	-	-	-
7	12 13 14 15 16 20 25 30		10.0~25.0	390	420	950	370	620	950	4,150	9,110	2,570
			25.5~50.0	550	570	1,020	530	770	1,020	8,040	13,550	4,850
8	12 13 14 15 16 20 25 30		50.5~75.0	620	670	1,130	600	870	1,130	-	-	-
			75.5~100.0	750	840	1,350	730	1,040	1,350	-	-	-
9	15 16 20 25 30	35 40 50	10.0~25.0	480	520	1,020	460	770	1,020	6,570	13,840	4,660
			25.5~50.0	840	870	1,380	810	1,170	1,380	8,820	18,540	6,030
10	15 16 20 25 30	35 40 50	50.5~75.0	1,000	1,080	1,610	970	1,400	1,610	-	-	-
			75.5~100.0	1,270	1,420	2,020	1,230	1,760	2,020	-	-	-
11	20 25 30	35 40 50	10.0~25.0	450	480	990	430	680	990	4,280	9,390	2,650
			25.5~50.0	610	640	1,050	590	840	1,050	8,280	13,960	5,000
12	20 25 30	35 40 50	50.5~75.0	750	790	1,170	730	990	1,170	-	-	-
			75.5~100.0	920	1,010	1,400	900	1,210	1,400	-	-	-
13	20 25 30	35 40 50	10.0~25.0	510	540	1,140	480	760	1,140	7,240	14,620	5,130
			25.5~50.0	890	930	1,560	860	1,220	1,560	9,430	19,540	6,540
14	20 25 30	35 40 50	50.5~75.0	1,060	1,120	1,910	1,040	1,400	1,910	-	-	-
			75.5~100.0	1,340	1,470	2,370	1,310	1,760	2,370	-	-	-
15	20 25 30	35 40 50	10.0~25.0	500	520	1,040	480	720	1,040	4,500	9,870	2,790
			25.5~50.0	670	720	1,110	650	920	1,110	8,710	14,670	5,250
16	20 25 30	35 40 50	50.5~75.0	840	920	1,230	820	1,120	1,230	-	-	-
			75.5~100.0	1,050	1,130	1,470	1,030	1,330	1,470	-	-	-
17	20 25 30	35 40 50	10.0~25.0	540	560	1,260	520	780	1,260	7,690	15,300	5,500
			25.5~50.0	940	1,010	1,740	910	1,290	1,740	9,940	20,290	6,850
18	20 25 30	35 40 50	50.5~75.0	1,120	1,230	2,210	1,100	1,500	2,210	-	-	-
			75.5~100.0	1,410	1,520	2,710	1,390	1,790	2,710	-	-	-
19	20 25 30	35 40 50	10.0~25.0	570	590	1,320	550	820	1,320	-	-	-
			25.5~50.0	990	1,060	1,820	960	1,350	1,820	-	-	-
20	20 25 30	35 40 50	50.5~75.0	1,180	1,300	2,320	1,160	1,590	2,320	-	-	-
			75.5~100.0	1,490	1,610	2,840	1,470	1,900	2,840	-	-	-
21	(25) 30 (25) ...V2のみ		10.0~25.0	620	650	1,100	600	850	1,100	4,720	10,360	2,930
			25.5~50.0	790	920	1,170	770	1,120	1,170	9,150	15,400	5,520
22	35 40 50		50.5~75.0	960	1,050	1,300	940	1,250	1,300	-	-	-
			75.5~100.0	1,180	1,300	1,550	1,160	1,500	1,550	-	-	-
23	35 40 50		10.0~25.0	570	600	1,680	550	780	1,680	16,710	15,910	6,390
			25.5~50.0	990	1,150	2,330	960	1,400	2,330	22,020	21,040	7,940
24	35 40 50		50.5~75.0	1,180	1,290	2,610	1,160	1,540	2,610	-	-	-
			75.5~100.0	1,490	1,640	3,220	1,460	1,890	3,220	-	-	-
25	35 40 50		10.0~25.0	600	630	1,760	580	820	1,760	-	-	-
			25.5~50.0	1,050	1,220	2,440	1,020	1,490	2,440	-	-	-
26	35 40 50		50.5~75.0	1,240	1,360	2,740	1,220	1,620	2,740	-	-	-
			75.5~100.0	1,570	1,730	3,380	1,540	1,990	3,380	-	-	-
27	40 50		10.0~25.0	600	630	1,800	580	820	1,800	17,830	16,710	6,850
			25.5~50.0	1,040	1,210	2,420	1,010	1,480	2,420	23,440	22,020	8,470
28	40 50		50.5~75.0	1,240	1,360	2,710	1,220	1,620	2,710	-	-	-
			75.5~100.0	1,570	1,730	3,320	1,540	1,990	3,320	-	-	-
29	40 50		10.0~25.0	640	670	1,890	580	870	1,890	-	-	-
			25.5~50.0	1,110	1,290	2,540	1,010	1,580	2,540	-	-	-
30	40 50		50.5~75.0	1,310	1,440	2,840	1,220	1,720	2,840	-	-	-
			75.5~100.0	1,650	1,820	3,490	1,540	2,090	3,490	-	-	-

◎CLJHT・CLJHF・CLJHP・CLJHEはH≤50

Order 注文例
 型式 - D - L
 CLJHM10 - 16 - 20.0

◎価格表記の無いものは規格がありません。